



02084435111  
sales@ultraflowuk.com  
ultraflowuk.com

## **ACE9.0 WATER HEATER 9KW**

### Operational Manual Instantaneous Electric Water Heater

Please read the instruction manual carefully before use, and keep it for future reference

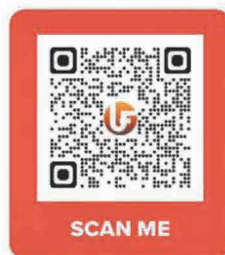

## IMPORTANT INFORMATION



**CORRECT INSTALLATION MODES**



**DANGEROUS**

### UNDERSTANDING PERFORMANCE:

The temperature and flow rate of the water entering the product determines how well it performs.

Flow rate - For higher performance (temperature), reduce the flow rate (use the below chart for guidance).

| DT (°C) | FLOW RATE (L/MIN) |
|---------|-------------------|
| 20      | 6.5               |
| 25      | 5                 |
| 30      | 4                 |

Ambient water temperature – The product can only heat the water by a certain amount of degrees ( $\Delta T$ ). In winter when the incoming water temperature is colder, the output water temperature will be less. Please reduce the flow rate to compensate.

### Warranty:

The warranty period is valid from your purchase date (please retain proof of purchase) and on condition that the unit was installed by a qualified electrician in accordance with the instructions enclosed in the unit

### Multipoint Use:

The unit can be connected to multi point but it is advised to use only one point at any given time

**PERFORMS BEST AT LOW  
FLOW TEMPERATURE**

# Preface

Dear User,

We sincerely thank you for using our electric water heater. This product is designed and manufactured in strict accordance with CE/ROHS national standards. In order to give full play to the excellent performance of this product, please carefully read the installation and use instructions of this product before installation and use, and please keep them properly for future reference.

Thank you for your cooperation!

|   |    |
|---|----|
| 1. Preface.....   | 1  |
| 2. Precautions .....  | 2  |
| 3. Product Packing List .....                               | 2  |
| 4. Purpose and Characteristics .....                        | 3  |
| 5. Electrical Schematic Diagram .....                       | 3  |
| 6. Technical Parameters and Installation Requirements ..... | 4  |
| 7. Product Structure Diagram .....                          | 4  |
| 8. Installation Precautions .....                           | 5  |
| 9. Installation Preparation .....                           | 5  |
| 10. Installation Environment .....                          | 5  |
| 11. Installation Method .....                               | 6  |
| 12. Standard Installation Diagram.....                      | 7  |
| 13. Check and Test Machine .....                            | 9  |
| 14. Product Usage Method .....                              | 9  |
| 15. Usage and Maintenance.....                              | 11 |
| 16. Fault and Treatment Method .....                        | 11 |

## Precautions

- In cold winter, if the water outlet temperature at the maximum operating gear of the water heater is not enough, please properly reduce the water intake. And increase the water temperature.
- The tap water inlet valve must be properly adjusted to maintain moderate water flow in the shower.
- If the water heater is not used for a long time in cold area in winter, drain the water to prevent ice.
- The water inlet must be equipped with sundries filter screen and regularly remove dirt from the shower and water inlet filter screen.
- Please try the water temperature with your hand before each use, and confirm the appropriate water temperature before use to avoid scalding.
- For the newly installed pipeline, please drain the impurities in the pipeline before connecting with the water heater for the first time.
- The outlet of this water heater shall not be connected to any faucet or joint not specified.
- Water inlet pressure: Maximum water inlet pressure 0.75MPa, minimum inlet pressure 0.1MPa

## Product Packing List

| Name                        | Quantity | Description  |
|-----------------------------|----------|--|
| Water heater                | 1        |  |
| User Manual                 | 1        |  |
| Water flow regulating valve | 1        |  |
| Accessory bag               | 1        | ①Plastic expansion anchor<br>②Screw ③Hook<br>④Sealing ring with filter |
| Shower set                  | 1        | ①Shower head<br>②Shower pipe   |

## Purpose and Characteristics

### ◆ Purpose:

The water heater is suitable for hot water bathing, dishwashing, laundry and rinsing in places such as families, enterprises and institutions and service industries.

### ◆ Characteristics:

**Security&Intelligence** security, beauty, durability and intelligence are the design purposes of this product.

**Ultra-thin Design** ultra-thin streamlined design, beautiful and elegant; LED display, intuitive visibility.

**Intelligent Self-test** automatically detects the working state and performance level of the machine to ensure safety.

**Low Pressure Startup** low water pressure startup, water and power on, no water and power off.

**Safe and Reliable** special power gear memory and automatic fault alarm function, safe and comfortable, time-saving and heart-saving.

**Easy to Use** multi-gear power selection, easy to adjust, to meet the needs of your four seasons; No water storage, There is no need to preheat and keep warm, and there is no need to wait.

## Electrical Schematic Diagram

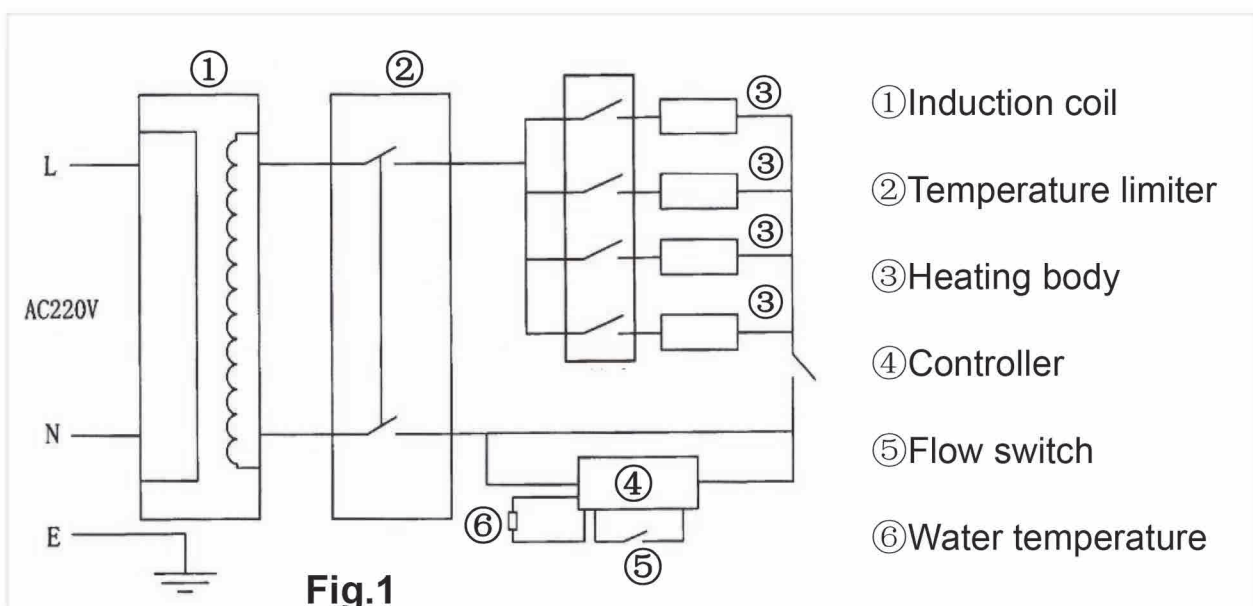

## Technical Parameters and Installation Requirements

| Rated power            | Rated current | Meter requirements                  |                  | Air switch  | Cross sectional area of power cord | Display                |
|------------------------|---------------|-------------------------------------|------------------|-------------|------------------------------------|------------------------|
|                        |               | Magnetic card electromagnetic meter | Mechanical meter |             |                                    |                        |
| 3500W                  | 16A           | ≥10[40]A                            | ≥10[40]A         | ≥32A        | ≥2.5mm <sup>2</sup>                | Yes                    |
| 4500W                  | 20.9A         | ≥10[40]A                            | ≥10[40]A         | ≥32A        | ≥2.5mm <sup>2</sup>                | Yes                    |
| 5500W                  | 25.0A         | ≥10[40]A                            | ≥10[40]A         | ≥32A        | ≥2.5mm <sup>2</sup>                | Yes                    |
| 7000W                  | 34.1A         | ≥10[40]A                            | ≥10[40]A         | ≥40A        | ≥4.0mm <sup>2</sup>                | Yes                    |
| 7500W                  | 34.1A         | ≥10[40]A                            | ≥10[40]A         | ≥40A        | ≥4.0mm <sup>2</sup>                | Yes                    |
| 8000W                  | 36.4A         | ≥10[40]A                            | ≥10[40]A         | ≥40A        | ≥6.0mm <sup>2</sup>                | Yes                    |
| 9000W                  | 39.1A         | ≥10[80]A                            | ≥10[40]A         | ≥60A        | ≥6.0mm <sup>2</sup>                | Yes                    |
| Minimum inlet pressure | 0.1MPa        | Control mode                        |                  | Manual      | Installation method                | Vertical<br>Horizontal |
| Maximum inlet pressure | 0.75MPa       | Water temperature regulation range  |                  | Within 65°C | Waterproof grade                   | IPX4                   |
| Rated voltage          | 220~240V      | Over temperature protection         |                  | 95°C        | Heating pattern                    | Cast aluminum          |

## Product Structure Diagram

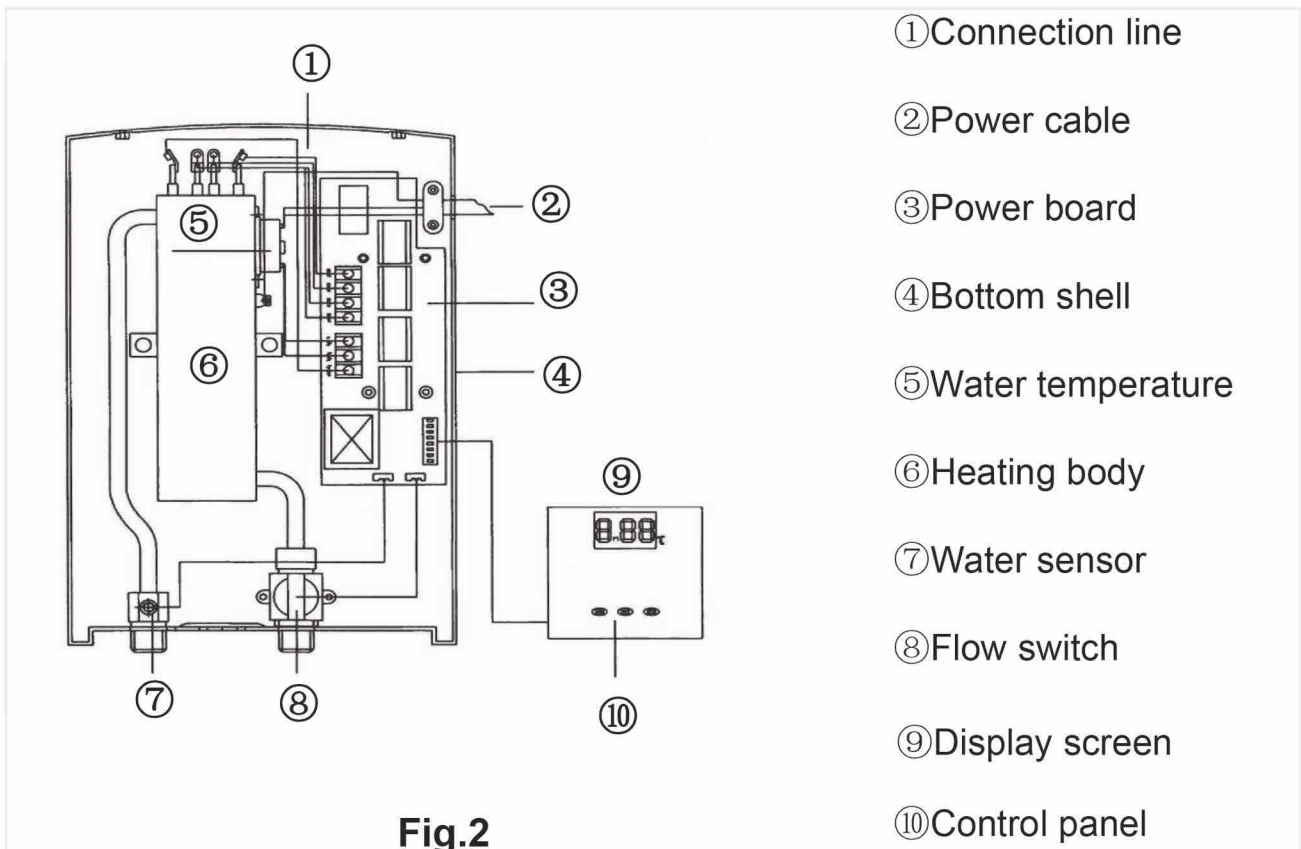

Fig.2

## Installation Precautions

- A. The water heater must be installed with reliable special grounding wire, and the tap water pipe and sewer pipe shall not be used as grounding.
  - B. The water heater must be equipped with a special leakage protection switch. When the water heater is not used, close the external leakage switch.
  - C. It is not allowed to install the water heater too close to the combustible. The water heater must be installed vertically to connect the waterway before power-on test machine.
- Warning: Do not energize the water heater when the water in the water heater may freeze.
- D. When the water heater is in use, if it is found that the power cord is damaged, the user must contact the manufacturer or vendor to replace the special power cord, and the general power cord shall not be used instead to avoid any accident.

## Installation Preparation

- A. The installer shall prepare the tools for installing the water heater and necessary inspection instruments with qualified metering.
- B. Check whether the water heater is in good condition and whether the accompanying documents and accessories are complete.
- C. Read the Installation Instructions carefully to understand the function, use method, installation requirements and installation method of the water heater to be installed;
- D. Check the power supply, water pressure, drainage and grounding of the user's house, and ask whether the wire diameter of the electric meter meets the requirements of the water heater to be installed. If it does not meet the installation requirements, install it after rectification.
- E. Assist the user in selecting the installation position of the water heater to ensure that the installation position of the water heater is safe and stable.

## Installation Environment

- A. Avoid leakage of flammable gas or environment with strong corrosive gas;
- B. Avoid artificial strong electric current and magnetic field direct action and inaccessible place for children;
- C. Avoid places where noises and vibrations can easily occur;
- D. The length of connection between water heater and water shall be shortened as far as possible. The well shall be installed in a place where it is easy to drain water and the water shall not be sprayed to the power supply when the water heater is used.
- E. The water heater is only for indoor use, and wall-mounted vertical installation is adopted.
- F. The installation surface of the water heater shall be firm and strong with certain strength equivalent to prevent affecting the normal operation of the water heater or

causing danger;

G. Since the power of the water heater is large, the electric meter, wire path and fuse of the user shall meet the requirements of rated current of the water heater to be installed.(Please refer to the "Technical Parameters and Installation Requirements" table for details)

## Installation Method

### ◆ Host fixed installation

First drill the screw hole for installing the hook on the solid and strong installation surface with a certain strength. The height from the hole to the ground shall be 1.5 m~1.7 m, and the distance between the hole and the hole shall be as shown in "Fig.3" Mark the positions of the screw holes in sequence with a pen. (Generally, the vertical parallel height should be eye-level, and the proposed height is about 1.5 m). Drill the hole on the wall with an impact drill, insert the the plastic expansion anchor into the hole, tighten the screw with a screwdriver, and fix the hook on the wall (as shown in "Fig.4"). Then insert the hanging plate of the water heater into the hook. (Note that the hook is completely inserted into the hanging plate to ensure that the water heater is firmly installed and can not be loosened).

### ◆ Waterway Installation

1. One end of the corrugated pipe is connected to the water inlet pipe of the water heater, and the other end of the corrugated pipe is connected to the tap water pipe with valve body switch. A sealing ring with a filter screen shall be padded between the joints.
2. Install the shower assembly at the water outlet pipe of the water heater.
3. If the optional electric wall is used, please install the electric wall at the outlet end of the water heater.
4. If the temperature regulating valve is selected, please install the temperature regulating valve at the water inlet of the water heater.
5. The attached new hose assembly must be used. The old hose assembly cannot be reused. It is forbidden to replace the original hose assembly at will.  
Shower, otherwise will affect the use effect.

### ◆ External Circuit Installation



1. Check the line: Before installation, check the rated current, electricity meter and power supply line whether the capacities match. (See Technical Parameters)
2. Install the air switch: Install the qualified air switch on the wall;
3. Line connection: Connect the power cord of the water heater with the air switch live wire and neutral wire L: live wire (brown) N: neutral wire (blue) E: ground wire (yellow and green), and then reliably connect the ground wire of the water heater power cord with the ground wire of the residence.

## Standard installation diagram



Fig.3

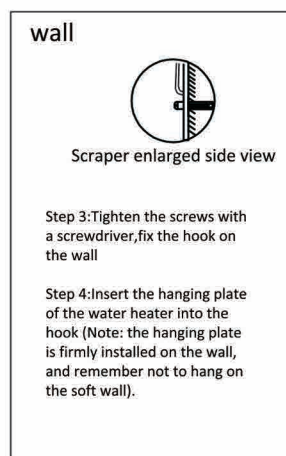

Fig.4

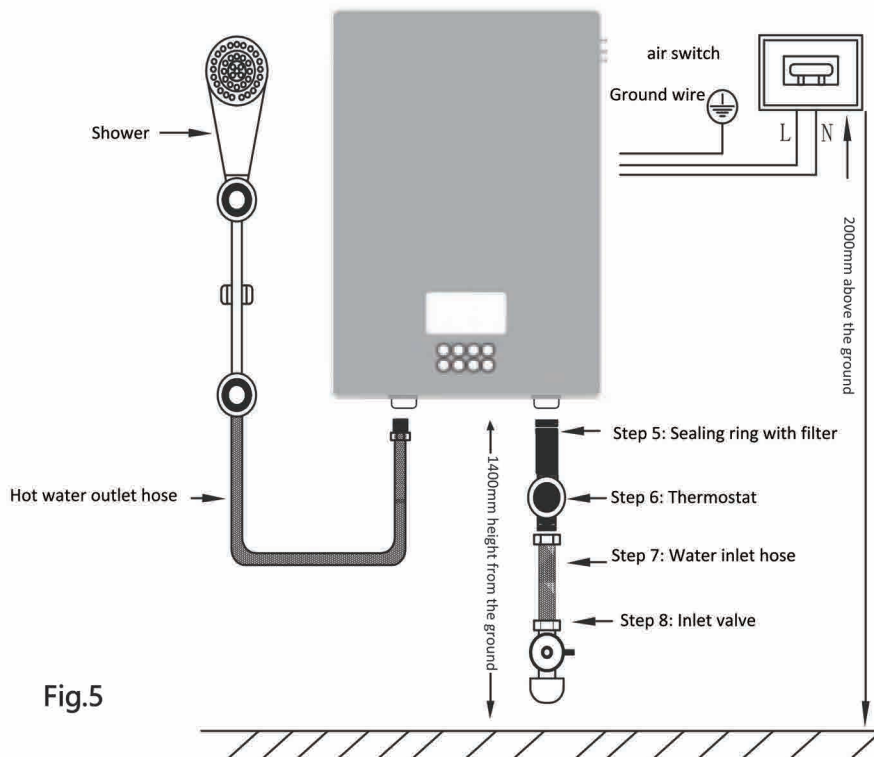

Fig.5

\*The appearance of the product is subject to the actual product, the picture is for reference only.

**WARNING: ALL WIRING AND INSTALLATION MUST BE SUPERVISED BY A SUITABLY QUALIFIED PERSON.**

**WARNING: DO NOT INSTALL WHERE IT MAY BE SUBJECTED TO FREEZING CONDITIONS.**

**Fig.6**  
Examples of fitted units

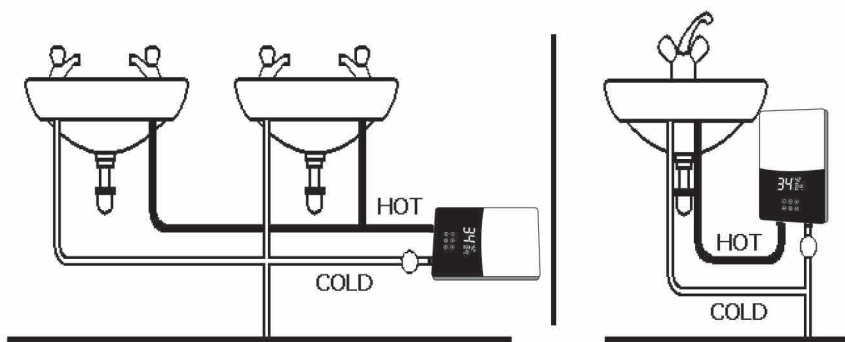

**Fig.7**  
Acceptable unit orientation

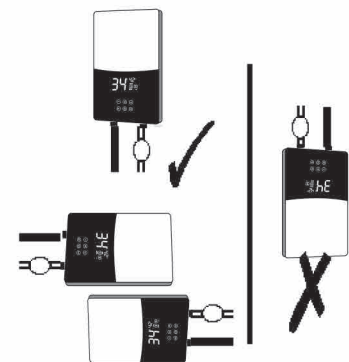

The unit is recommended to supply a **MAXIMUM** of two washbasins (see fig.6)

**OR** a washbasin and shower (see fig.8)

If the Unit is connected to a mixer tap then only **NON**-Thermostatic types should be used (water mixes at the outlet pipe only).

The Unit is **NOT** to be fitted to a bath or kitchen sink other than for hand-washing purposes.

The unit **MUST NOT** be mounted upside down (fig.7).

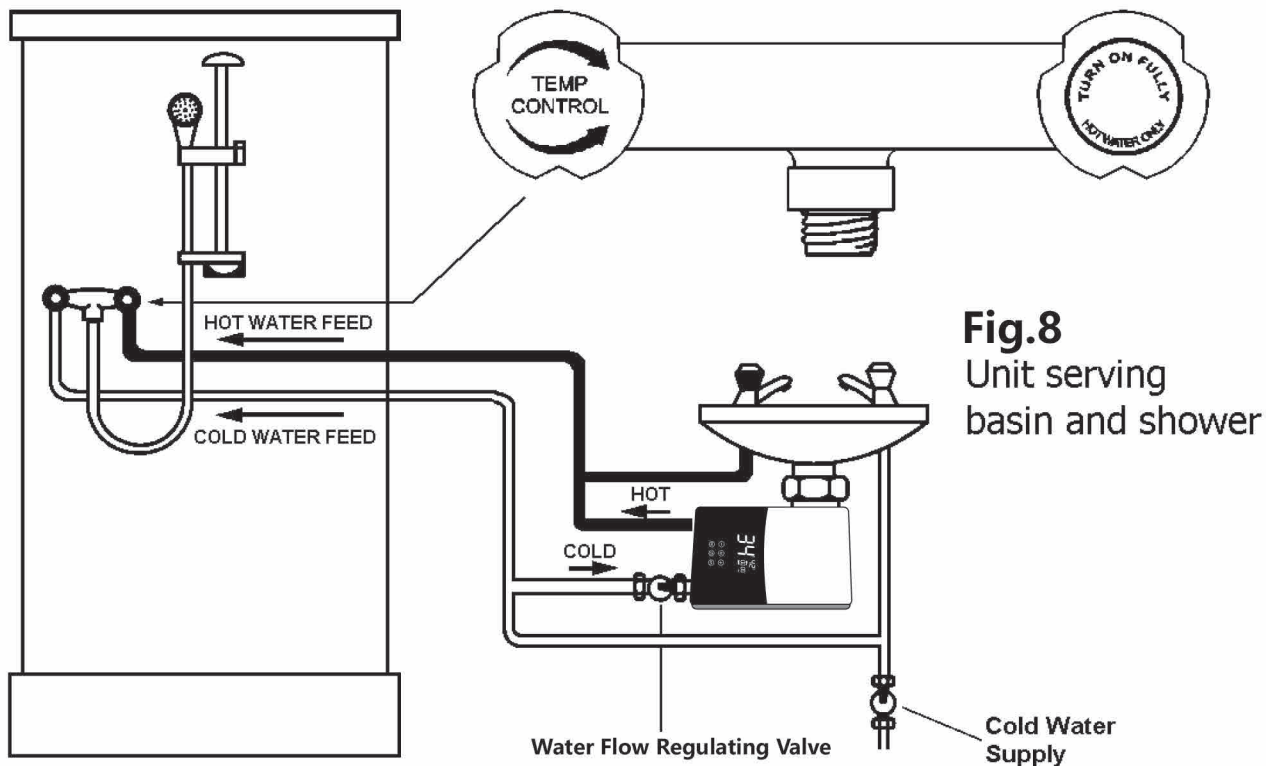

**Fig.8**  
Unit serving basin and shower





## Check and Test machine

After installing the water heater, the installation shall be checked, and special attention shall be paid to:

1. The pipeline connection shall be reasonable in direction, and there shall be no leakage at each connection;
2. Electrical appliances shall be configured safely and correctly;
3. The mechanical connection shall be firm and reliable;
4. The use function shall be well realized and the control component shall operate normally; Water heaters shall be commissioned in accordance with the requirements of these specifications;

## Product Usage Method

After confirming the installation of the water circuit and circuit of the water heater, first open the water to make the water outlet of the water heater flow out, close the water valve, and then operate the water heater according to the following methods:

1. Close the hand brake of the leakage protection switch to energize the water heater. At this time, the buzzer of the water heater beeps.
2. Press the "  " key below the display screen, and the display screen will light up.
3. Press the "  " key to increase the set temperature. The set temperature on the display screen changes numerically. Each time you press the "  " key, the temperature rises by one degree, and the maximum temperature rises to 55 °C. (Generally, 40-42 °C is more suitable for bathing)
4. Press the "  " key to lower the set temperature and change the set temperature number on the display screen. Each time you press the "  " key to lower the temperature by one degree, the most slender is reduced to 30 °C. (Generally, 40-42 °C is more suitable for bathing)

5. After the temperature is set, open the water inlet valve to make the water outlet of the water heater, the water heater enters the heating state, and the temperature of the water outlet gradually rises. When the temperature fails to reach the set temperature, use the water epidemiological investigation throttle valve to adjust the water flow.

When the water heater cannot enter the heating state, the following solutions shall be used:

- A. Adjust "water flow valve" or inlet angle valve to increase water flow.
- B. Check the filter mat at the water inlet for blockage and clean the mat.
- C. Check whether the Anti-electric wall or shower head is blocked by sundries, and rinse and clean.
- D. If the above methods are invalid, it may be that the starter switch in the machine is blocked by sundries. Please pass tap water through the "water outlet" of the machine and flow out from the "water inlet" of the machine. After a few minutes of back flushing, connect the tap water pipe back to the normal position.
- E. If the water pressure is low (the self-built water tower is used in some areas), add a booster pump at the water inlet to increase the water pressure.

#### ★ Special advice

- When using water each time (including shutting off the water before boiling it), be sure to test the water temperature by hand, and make sure the water temperature is suitable before using water to avoid scalding.
- When used by an elderly person or a child, be guided by someone familiar with the operation of the product.
- The maximum water temperature does not exceed 55 °C , when the outlet water temperature reaches 60 °C, the machine will be confirmed as over-temperature and automatically stop heating.

## Usage and Maintenance

1. Check whether the power cable and the air switch are in good contact and whether the grounding wire is reliably grounded;
2. tap water contains a lot of impurities, which are easily deposited in the shower head holes and filter screens without cleaning for a long time, resulting in poor or even blocked water outflow, affecting the use or even damaging the water heater, so it is necessary for regular cleaning;
3. When the water heater is not used for a long time, close the water inlet valve and external power switch of the water heater.
4. Power cord damage must be replaced by maintenance personnel designated by the manufacturer or distributor and special power cord used;
5. The maintenance of water heater must be carried out by professional personnel;
6. Before cleaning the water heater, cut off the power supply, dip a small amount of neutral cleaning agent with a damp cloth, do not use gasoline or other solutions, and finally dry with a dry cloth to keep the water heater dry.

## Fault and Treatment Method

| Fault phenomenon   | Cause analysis   | Treatment   |
|--|--|---|
| 1. Water leakage at water inlet and outlet pipe connection | A、 Poor connection of inlet and outlet pipes<br>B、 Damaged sealing gasket for connection                         | A、 Reconnection<br>B、 Replace gasket  |
| 2. No indication on digital display                        | A、 power not on<br>B、 monitor damaged<br>C、 water heater internal temperature protection thermostat disconnected | A、 power up switch<br>B、 Replace Monitor<br>C、 Contact maintenance department |
| 3. Key out of control                                      | A. Button or circuit board damage  | A. Replace key or circuit board   |
| 4. Water temperature is too high                           | A、 set temperature is high<br>B、 Everlasting is too small.   | A、 lower the set temperature<br>B、 Increase water yield                       |
| 5. Water temperature is too low                            | A、 low set temperature<br>B、 Volume too large  | A、 Adjust the set temperature<br>B、 Reduced water output                      |
| 6. Less and less water is discharged                       | The inlet filter screen or flower wine is blocked by dirt in the water   | Cleaning filters and showers  |
| 7. Alarm display "E1"                                      | Indicates leakage of water heater  | Contact maintenance department  |
| 8. The alarm displays "E2"                                 | Indicates water outlet probe fault   | Replacing water outlet probe  |
| 9. Alarm display "E3"                                      | Indicates flow switch failure  | Replace water flow switch   |
| 10. Alarm display "E4"                                     | Indicates overtemperature fault  | Replacing temperature probe   |